

5150 High Voltage Tester & Automation Controller

The 5150 provides a flexible platform for both small harness testing and the automation environment. When running Cirris Easy-Wire software, the 5150 delivers quick, powerful setup for testing of wire harnesses. When running Cirris Application Specific Test (AST) software, the 5150 is perfectly tailored to integrate with other automated equipment or be used as an automation controller. Multiple 5150 units can be used together to control a production line while integrating into your own MES or ERP systems.

Product Features

- **Integrated PC** – The unit’s internal Windows PC provides easy connectivity for network data sharing, network and local printers, barcode scanners, and other PC peripherals.
- **Flexible Display** – In addition to the integrated touchscreen, the tester can connect to external monitors.
- **Fastest Testing** – Configured with Cirris High Speed Test Points, the unit uses solid state circuitry to maximize low voltage testing speed and relays to complete high voltage tests.
- **Complex Measurements** - Cirris Advanced Test Points provide the maximum range of test flexibility and external instrument integration for the most demanding test applications.
- **Automation Communication** – As an automation controller, the 5150 can be easily configured for machine/PLC communication protocols such as ProfiNET, EtherNet/IP, TwinCAT, OPC-UA, MQTT, and Modbus.
- **Digital IO** – Add optional Digital I/O modules to expand the functionality and control of the unit or other devices.
- **Temperature and Humidity Control** – To ensure operational performance in even the toughest environments, the tester is equipped with internal sensors to monitor temperature and humidity
- **RFID Reader** – Allows user to identify themselves quickly and securely to the tester using an RFID tag, thereby providing security and control of available functions.
- **Cirris AST Software** – When used as an automation controller, AST allows the maximum flexibility to customize the test process, communicate with the user, and interface with automation equipment. Customize what an operator sees to fit your needs.
- **Easy Serviceability** - For ease of service and upgrade mobility, each card has an LED indicator that allows for quick error diagnosis and field service replacement. Add or change a module with just two screws.
- **Safety Interlock** - Provides for the integration of safety interlock and warning indicators. The unit has true shutoff capability for safety during testing.

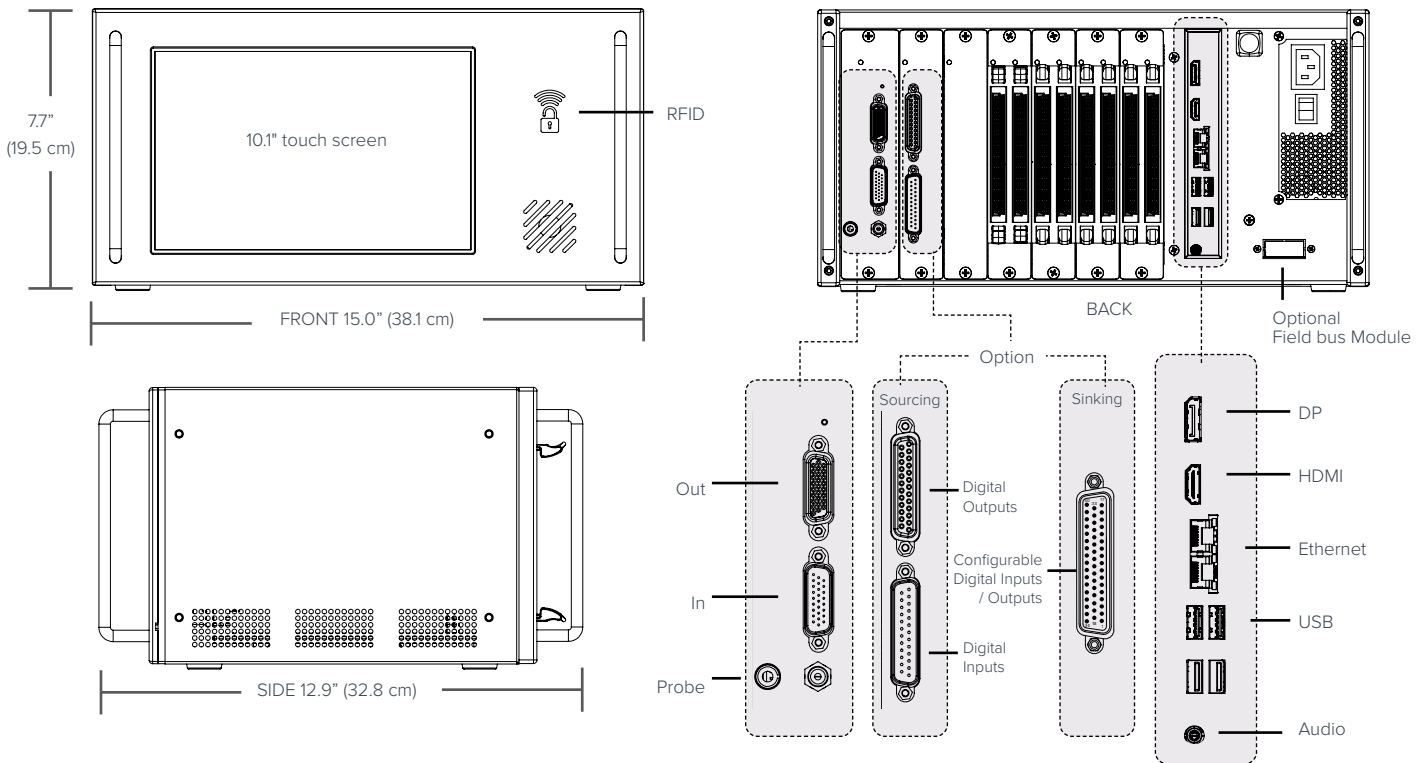

5150 Specifications | Visit cirris.com/5150 or call +1-801-973-4600

Test Points

64 to 768 points in 64 point increments

Low Voltage Test

■ 2 Wire

Voltage: 3.3 VDC standard

Current: 0.1 μ A to 10 mA

Resistance: 0.1 Ω to 10 M Ω \pm 2% \pm 0.1 Ω

■ 4 Wire

Voltage: 3.3 VDC standard

Current: 0.1 μ A to 2 A

Resistance: 0.001 Ω to 10 M Ω \pm 2% \pm 0.001

Component Tests

Diodes: 0 to 6 VDC standard (0-30V with Adv Instructions)

Resistors: 0.1 Ω to 10 M Ω \pm 2%

Capacitors: 10 pF to 5000 μ F \pm 10% \pm 50 pF

Twisted Pairs: Verify proper pairing in twisted pair cables

High Voltage Test

■ Insulation Resistance Test

Voltage: 10 to 1500VDC \pm 5% \pm 5 V

Resistance: 5 M Ω to 3 G Ω \pm 10% (Optional 10 G Ω \pm 10%)

■ Dielectric Withstand Test

Voltage: 10 to 1500 VDC \pm 5% \pm 5 V or 10 to 1070 VAC \pm 5% \pm 5 V

Current Limit: (DC) 10 μ A to 2.5 mA, (AC) 10 μ A to 2.5mA (RMS)

Max Capacitance Per Net: 30 nF @ 1500 VDC;
6.3 nF @ 1000 VAC

HV Energy Limit: 35 mJ

HV Charge Limit: 45 μ C

Max Points Per Net

Unlimited

Digital Input/Output (optional)

Sourcing (PNP): 16 inputs, 16 outputs, 12 V - 24 V

Sinking (NPN): 20 configurable Inputs/Outputs, 8 Outputs,
3.3 V - 24 V

Test Point Modules

High Speed Test Points 64pt: Single relay per test point for high voltage switching. Uses solid state circuitry to maximize test speed during low voltage testing.

Advanced Test Points 64pt: Two relays per test point, allowing external meter integration, floating selected nets to isolate high voltage and capacitance measurements, optionally allows stimulus up to 30 VDC 10mA during low voltage testing.

Flex Test Points 32pt: Dual-function module enables testing and energizing up to 60VDC/2A or 40 VAC/1.4A RMS on each point. Supports external meter integration and can be combined in systems with Advanced Test Point modules.

Low Voltage Only Test Points 64pt: For complex functionality without High Voltage. The system can be field upgraded with HV scanner replacement modules and adding an HV module.

Test Point Interface

96 pos. Female VME Eurocard connector-32 pos. loaded

Power

115 / 230 V 50/60 Hz

Size & Weight

15.0" W x 7.7" H x 12.9" D (38.1 cm x 19.5 cm x 32.8 cm)

25 lbs (11.34 kg)

*Specifications listed reflect use of Advanced Scanner and High Voltage modules. Specifications vary by tester module configuration.